

CONTROLLERS & CABINETS:

 RETAIN AND PROTECT EXISTING CONTROLLER AND CABINET.

 RETAIN AND PROTECT EXISTING JUNCTION BOX.

POLES:

 RETAIN AND PROTECT EXISTING MAST ARM POLE.

DETECTION:

 INSTALL RADAR DETECTION UNIT (T=RADAR).

 INSTALL ARC6 CABINET INTERFACE DEVICE (CID) AND MOUNTING SHELF FOR RADAR DETECTION SYSTEM.

 INSTALL SYNCHRONOUS DATALINK CONTROL (SDLC) CONNECTION.

CONDUITS:

 S" RETAIN AND PROTECT EXISTING (S) INCH ELECTRICAL CONDUIT.

 TRIM OR LOWER EXISTING CONDUIT(S) AS DIRECTED TO PROVIDE CLEARANCE TO JUNCTION BOX LID.

WIRES & CABLES:

 RETAIN AND PROTECT EXISTING WIRES.

 INSTALL RADAR CONTROL CABLE (T=RADAR).

 REMOVE EXISTING DETECTOR LOOP WIRES.

GENERAL NOTES:

1. THE INSTALLATION OF ALL RADAR DETECTION EQUIPMENT TO BE FIELD VERIFIED BY ODOT AND REPRESENTATIVE FROM RADAR VENDOR, ADVANCED TRAFFIC PRODUCTS. WIRING CONNECTIONS TO EXISTING SYSTEM TO BE COMPLETED BY CONTRACTOR. SET-UP, CALIBRATION, AND PROGRAMMING TO BE PERFORMED BY THE RADAR VENDOR. CONTRACTOR TO COORDINATE WITH RADAR VENDOR AND PROVIDE BUCKET LIFT FOR RADAR POSITIONING ADJUSTMENTS DURING SET-UP PROCESS.
2. MAINTAIN AND KEEP EXISTING SIGNALS IN STANDARD OPERATION AT ALL TIMES BETWEEN 6 AM - 10 PM. TEMPORARY SIGNAL SHUTDOWN SHALL BE ALLOWED BETWEEN 10 PM - 6 AM. FLAGGING MUST BE PROVIDED DURING TEMPORARY SIGNAL SHUTDOWN.
3. NEW RADAR DETECTION SYSTEM SHALL BE INSTALLED, CONFIGURED AND FULLY OPERATIONAL PRIOR TO ANY CONSTRUCTION ACTIVITIES THAT WILL IMPACT EXISTING SIGNAL LOOP DETECTION AND OTHERWISE IMPACT SIGNAL OPERATION, TIMING AND PHASING.
4. EXISTING LOOP DETECTORS TO BE ABANDONED ONCE RADAR DETECTION SYSTEM IS FULLY OPERATIONAL AND PRIOR TO CPPR AND FINAL PAVING OPERATIONS.

SUPPLIED MATERIALS		
QUANTITY	MODEL NO.	DESCRIPTION
2	102-0594	EXPANSE ARC6 (SURGE CARD NOT INCLUDED)
8	102-0562	SMART SENSOR SURGE CARD FOR (ARC2, ARC5, ARC6)
2	102-0486	19" ARC RACK BRACKET
8	WX-SS-225	WAVETRONIX MATRIX STOP BAR SMARTSENSOR
8	101-0471	MATRIX SNOW VISOR WITH ROTATING BACKPLATE
8	WX-SS-704-080	80 FOOT 6 CONDUCTOR MATRIX / 200V CABLE W/ CONNECTOR
2000	ATP-MATRIX 2	MATRIX TYPE 2 HOME RUN CABLE 1 PR #18, 2 TRIADS #22
8	102-0453 (MINI-710)	MINI 710 - SENSOR CABLE JUNCTION BOX W/ TERMINAL BLOCKS
8	WX-SS-611	SENSOR MOUNT - 6" 2 AXIS ALUMINUM BRACKET
2	WS-SDLC-2070-650	5' SDLC CABLE-2070 (25 PIN SCREW) TO CLICK 650 (15 PIN SPRING CLIP)

Y:\Projects\Roseburg\_City of027 Garden Valley Ramps\CAD3\_WORKING\Stewart\RADAR PLANS.dwg 5/30/2025 1:13 AM Elizabeth Wilson

NO.		DATE	BY	REVISION		SCALE		DESIGNED:					900 SE DOUGLAS AVE. ROSEBURG, OR 97470	CITY PROJECT #: 25PW01 CITY PROJECT MANAGER JESTEN BRENNER	RADAR DETECTION - LEGEND		2025 STEWART PKWY PAVEMENT AND CURB RAMP IMPROVEMENTS SCH A MAY 2025		SHEET NO.		
1		05/30/25		PLC	ADDENDUM #3		PLAN	HORIZ.	CWE										TS-01		
									PROFILE										VERT.	CWE	
							CHECKED:								P. CHADBOURNE CWE PROJECT NO. 40193.027.01						
							ONE INCH (REF)														
															5500 MEADOWS RD. #250   LAKE OSWEGO, OR 97035 WWW.CENTURYWEST.COM   503.419.2130				13 OF 25		
									EXPIRES: DEC 31, 2025												



Y:\Projects\Roseburg, City of\027 Garden Valley Ramps\CAD\WORKING\Stewart\RADAR PLANS.dwg 5/30/2025 1:13 AM Elizabeth Wilson

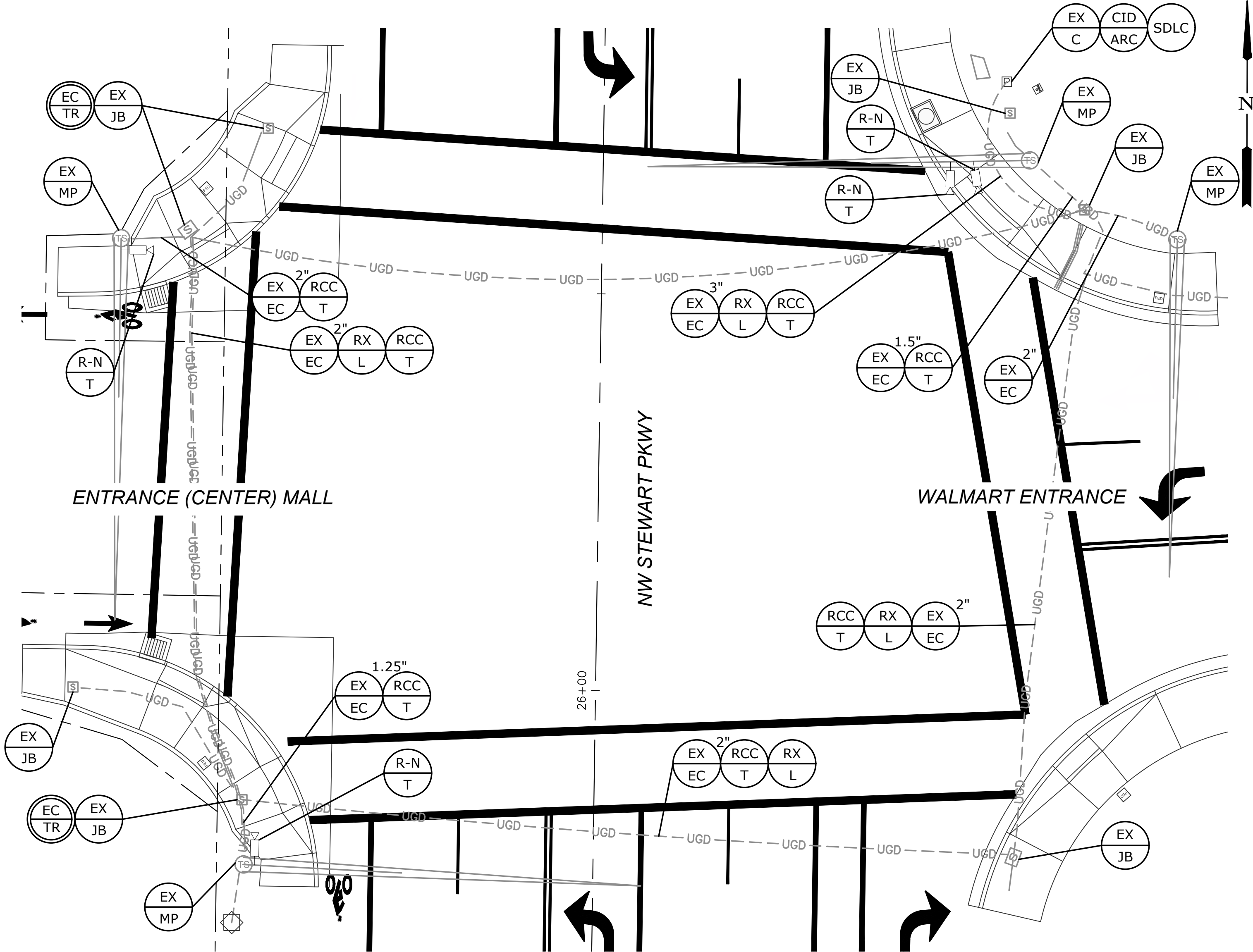

PLAN VIEW  
SCALE: 1"=10'

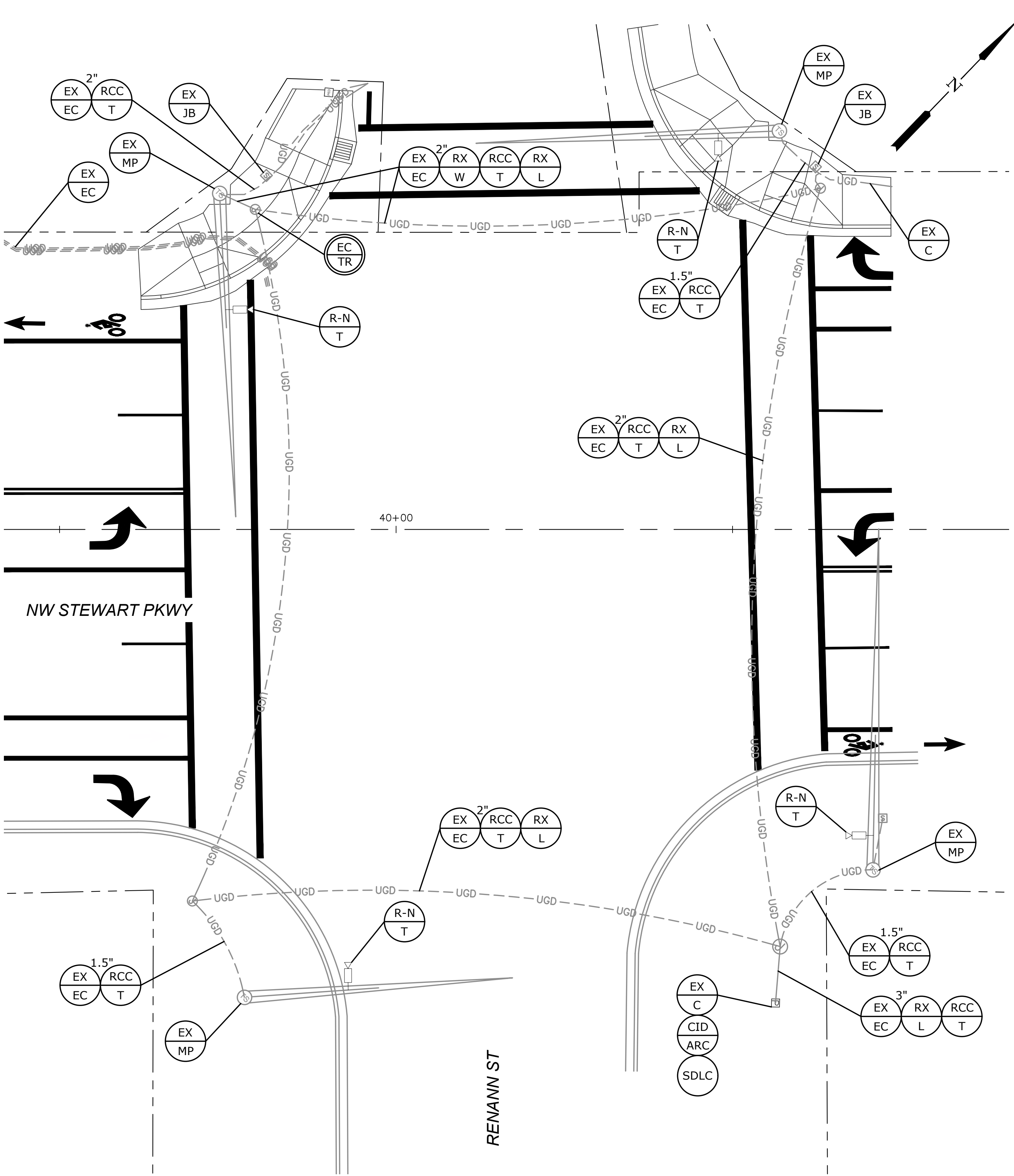

PLAN VIEW  
SCALE: 1"=10'

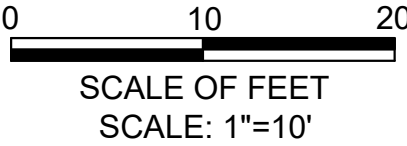

- NOTES:
- SEE SHEET TS-01 FOR LEGEND.
  - ABANDON EXISTING LOOP DETECTOR.
  - CONDUIT TO BE TRIMMED DOWN AS DIRECTED TO PROVIDE A CLEARANCE FOR JUNCTION BOX.

NO.	DATE	BY	REVISION
1	05/30/25	PLC	ADDENDUM #3

SCALE	
PLAN	1" = 10'
	HORIZ.
PROFILE	VERT.
ONE INCH (REF)	

DESIGNED:	CWE
DRAWN:	CWE
CHECKED:	P. CHADBOURNE
CWE PROJECT NO.	40193.027.01



**CENTURY WEST**  
ENGINEERING

5500 MEADOWS RD. #250 LAKE OSWEGO, OR 97035  
WWW.CENTURYWEST.COM 503.419.2130

**THE CITY OF ROSEBURG**

900 SE DOUGLAS AVE.  
ROSEBURG, OR 97470

CITY PROJECT #: 25PW01  
CITY PROJECT MANAGER  
JESTEN BRENNER

**RADAR DETECTION PLAN**

2025 STEWART PKWY  
PAVEMENT AND CURB RAMP IMPROVEMENTS SCH A  
MAY 2025

SHEET NO.
TS-02
14 OF 25